

Air Tight URBAĪ New Construction Housing with Emergency Driver

SUITABLE FOR DAMP LOCATION / WET LOCATION WITH SHOWER TRIM

“NON-IC” Type

NWUR3-120D1-EM, NWUR3-120E1-EM, NWUR3-277D1-EM, NWUR3-UV1-EM
 NWUR4-120D1-EM, NWUR4-120E1-EM, NWUR4-277D1-EM, NWUR4-UV1-EM
 NWUR3-120D2-EM, NWUR3-120E2-EM, NWUR3-277D2-EM, NWUR3-2772-EM, NWUR3-120EB2-EM, NWUR3-UV2-EM
 NWUR4-120D2-EM, NWUR4-120E2-EM, NWUR4-277D2-EM, NWUR4-2772-EM, NWUR4-120EB2-EM, NWUR4-UV2-EM

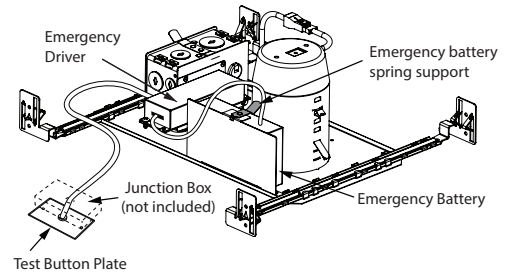

1. SHUT OFF ELECTRICAL SUPPLY AT SOURCE.
2. Locate position of mounting frames and install before the ceiling material board. Fasten the mounting frame to the wood joists (or other ceiling type) with the adjustable mounting bars (10" to 24,5"). To shorten the bars to 10", remove bars and cut off at the notch (See adjustable mounting bars detail view).
3. Once the correct bar length is known, fold down and press tabs to lock the plate to the mounting bars. Using pliers, tighten the U-shaped hooks on the T-bars.

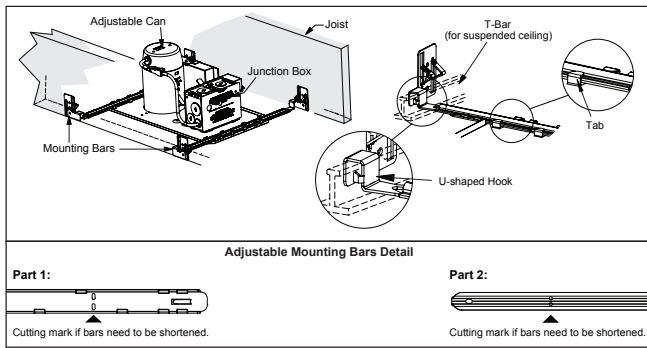

4. Bring the electrical wiring to the housing junction box as per applicable local electrical codes. Open the junction box and connect the wires based on the diagrams below. Close the junction box.

CONNECTIONS DIAGRAM

Note: For proper charging and function of emergency driver, an unswitched hot conductor must be connected to the emergency system independent of the driver power.

ELV Dimmer or no dimmer.

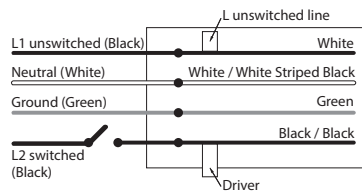

0-10V Dimmer

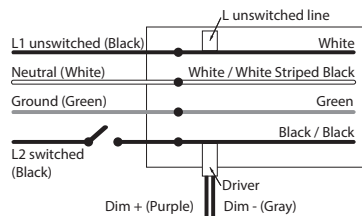

5. Unlock the upper part of the can captive hooks in order to release them.

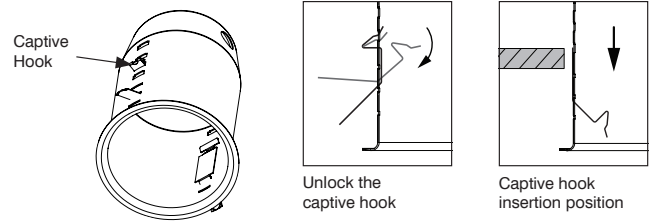

6. Remove the can.

7. Disconnect the can.

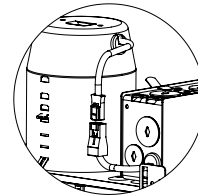

8. Install the ceiling material and locate the center of each fixture on the ceiling material.

9. Cut a hole to a diameter of:
NWUR3 (3-1/2") Series: Ø 3-5/8" (92 mm)
NWUR4 (4") Series: Ø 4-1/4" (108 mm)

10. Connect the housing wires to the can wires. Use the various adjustment holes on each side of the can and adjust the position of the captive hooks according to the ceiling thickness.

Note: Captive hooks are preinstalled for 1-3/8" (35 mm) ceiling thickness. Adjustment possibility up to a maximum of 2" (51 mm) ceiling thickness.



11. Lock the captive hooks and make sure the hooks apply a pressure against the ceiling to maintain the can firmly in place.

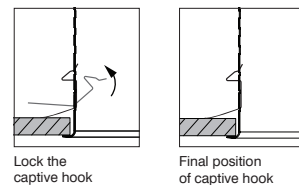

INSTALLATION OF ALUMINUM TAPE

- 12. Remove the film on the back of the included aluminum tape.
- 13. Apply the aluminum tape on both sides of the can in order to cover the hooks openings.

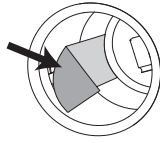

- 14. Complete the installation.

Connect the male and female connectors.

Push the connected wires in the pot, then push the trim in.

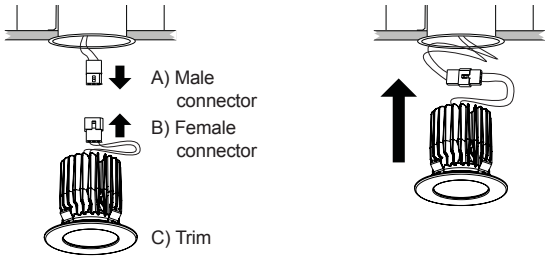

- 15. Install the test button near the housing with the plate included. Screw the plate on the junction box.
Note: The junction box is not included with the housing.

Emergency Driver Replacement (Follow your local electrical code)

1. **SHUT OFF ELECTRICAL SUPPLY AT SOURCE.**
2. Remove trim from can and disconnect wires.
3. Remove screws from can. Remove can from ceiling and let it hang.
4. Insert your hand in the aperture and remove the battery retained by a spring. Unplug the wire of the battery located at the end of the driver.
5. Install the new battery in the holder and connect the wire to the driver.
6. Put back the can in place.
7. Reconnect the wires and install the trim in place.

Please keep these installation instructions for future maintenance.



WARNING

The use of other company's (non-Contraste) products or components (e. g. trims) in conjunction with Contrast Lighting M.L. Inc. products may not be covered by UL approvals and could be hazardous. Such use automatically voids all Contrast Lighting M.L. Inc. warranty and responsibility of these products.



WARNING: RISK OF FIRE

Most dwellings built before 1985 have supply wires rated 60° C. Consult a qualified electrician before installing.

Due to constant evolution of dimmers, we must test them regularly.

We invite you to frequently visit our web site to find our dimmer compatibility list: www.contrastlighting.com

WARRANTY: CONTRAST LIGHTING M. L. INC. guarantees the components against manufacturing defects for a period of one (1) year, under normal use with proof of purchase. The obligation of the manufacturer consists in the cost of the components and does not cover the cost of labor and transport for replacement. For all claims, please contact your local supplier. See our Web site for additional warranty details. **Note:** 5-years warranty on driver and LED module.

CONTRASTE

1009, rue du Parc Industriel
Lévis (Québec) G6Z 1C5 Canada

Tel.: 1-888-839-4624
Fax.: 1-877-839-7057

contrastlighting.com
info@contrastlighting.com

© 2017 Contrast Lighting M.L. Inc.
All rights reserved

EC694 (Rev. A)
104284