

FRB1 - FRB2

Fire Rated Barrier for ceiling

SPECIFICATIONS

DETAILS	Metallic enclosure used for all types of recessed Housings IC and Non-IC, see compatibility chart below.	
DIMENSIONS	1: 20,20" L x 12,20" W x 9,50" D	2: 20,20" L x 12,20" W x 6,70" D
WEIGHT	1: 8,7 lbs	2: 7,1 lbs
LISTING	UL 263, ASTM E119, NFPA251, UBC7.1, ANSI A2.1, ULC S101	
RATING	1 Hour ASTM E119 against active Fire	
INSTALLATION	<ul style="list-style-type: none"> For installation in a 2 x 10" (FRB1) and 2 x 8" (FRB2). Fit within 16" and 24" On Center truss. A maximum of 2 standard 3C-12AWG "Romex" wires shall penetrate the enclosure as per FRPS written installation instructions. Apply Firestop seal to fill voids and cavities around the power supply electrical knockouts. <ul style="list-style-type: none"> Maximum 2 Fixtures/36 square feet. Minimum On Center 24" within same truss cavity. Minimum On Center 36" for adjacent truss cavity. <p>(Make sure you meet the local building code.)</p>	

COMPATIBILITY

	FRB1	FRB2
LINE VOLTAGE	Insulated Housing New Construction Remodel	Insulated Housing Excluding "Twist 'n Lock" (GU10) * New Construction Remodel
LOW VOLTAGE	Insulated Housing New Construction Excluding NWD/NWT * Remodel	Insulated Housing New Construction Excluding NWD/NWT * Remodel
FLUORESCENT	Insulated Housing New Construction 4" non emergency housing only * Remodel	Insulated Housing Excluding ISF2000, ISF2000L * New Construction 4" non emergency housing only * Remodel Excluding F6VXXX *
HID	New Construction Excluding NWMH8" * Remodel (MH)	New Construction Excluding NWMH8" * Remodel
LED	Insulated Housing Excluding ISLED300LU2 * New Construction Remodel	Insulated Housing Excluding ISLED300LU2 * New Construction Remodel

***Consult Contrast Lighting for more information about housing compatibility.**

ORDERING CODE

MODEL	OPTIONS
FRB	
FRB	1 20,20" L x 12,20" W x 9,50" D
	2 20,20" L x 12,20" W x 6,70" D

Project	
Notes	
Fixture Type	
Date	

FRB1

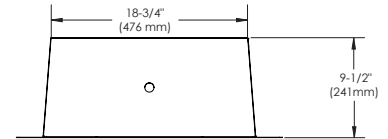
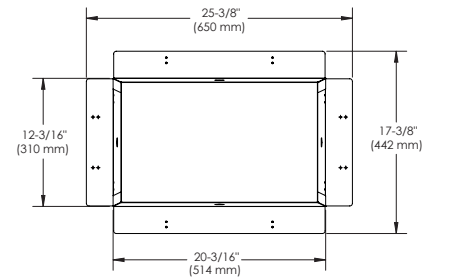
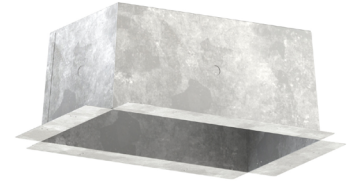

FRB2

