

ISUR4

4" URBAI Series

Classic IC and Air Tight New Construction Housing



Project _____

Notes _____

Fixture Type _____

Date _____

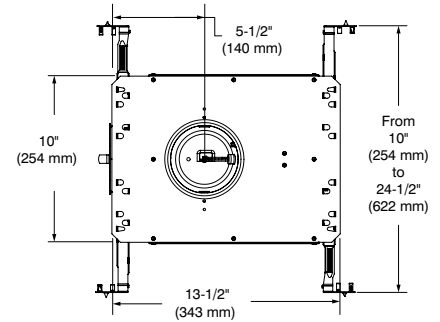
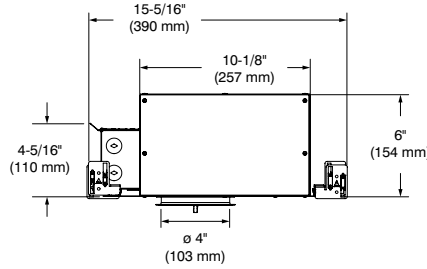

SPECIFICATIONS

HOUSING DETAILS

Up to 0,051" (1,3 mm) thick galvanized steel housing with integrated "IC" box.
 Approved for installation in insulated ceilings and in direct contact with insulating material (except polyurethane).
Conformity option for direct contact with polyurethane in performance 1 only (P option).
 33-1/2 in³ junction box.
 Below-ceiling accessible.

MOUNTING

Cutout diameter: ø 4-1/4" (108 mm)
 Can fit ceilings up to 2" (51 mm) thick.
 Requires a 6" (152 mm) clearance beyond the ceiling material.
 Snap-in hooks for ease of installation and a perfect fit to ceiling.
 Mounting bars extend from 10" (254 mm) to 24-1/2" (622 mm) to fit in most ceilings.
 No light leakage.

POWER

1: 10W IC - up to 1,018 lms
 2: 15W IC - up to 1,326 lms
 Warm Dimming: 15W - up to 650 lms

VOLTAGE

120 Volts
 277 Volts

DIMMING

ELV: 120V only
 0-10V: Sourcing driver (Sinking Control) 120V or 277V
 We invite you to consult frequently our Website to find our dimmer compatibility list:
www.contrastlighting.com

COMPATIBLE TRIMS

UR4A, UR4B, UR4C, UR4D, UR4E, UR4G, UR4H, UR4J, UR4K.

CERTIFICATION

- cULus **E343977** for damp locations; wet with shower trim only.
- ASTM E283
- Chicago City code compliance option available (Chicago Plenum (P option)).

WARRANTY

1 year on components against manufacturing defects.
 5 years on LED arrays and drivers.

ISUR4

4" URBAĪ Series

Classic IC and Air Tight New Construction Housing



CODIFICATION EXAMPLE FOR 120V

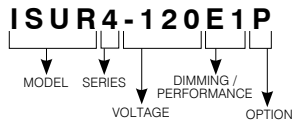

ORDERING CODE for 120V

MODEL	SERIES	VOLTAGE	DIMMING / PERFORMANCE	OPTION
ISUR	4	-120		
ISUR Classic IC and Air Tight New Construction	4 4" Series	-120 120V	E1 ELV / 10W E2 ELV / 15W EB2 ELV (+Value) / 15W D1 0-10V / 10W D2 0-10V / 15W	P* Chicago Plenum and Polyurethane

* **Chicago Plenum / Polyurethane with performance 1 (E1P and D1P)**
Chicago Plenum only with Performance 2 (E2P, EB2P and D2P)

CODIFICATION EXAMPLE FOR 277V

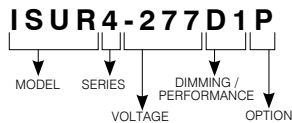

ORDERING CODE for 277V

MODEL	SERIES	VOLTAGE	DIMMING / PERFORMANCE	OPTION
ISUR	4	-277		
ISUR Classic IC and Air Tight New Construction	4 4" Series	-277 277V	D1 0-10V / 10W D2 0-10V / 15W 2 Non-Dimmable / 15W	P* Chicago Plenum and Polyurethane

* **Chicago Plenum / Polyurethane with performance 1 (D1P)**
Chicago Plenum only with Performance 2 (D2P and 2P)

SPECIFICATION SHEET

ISUR4**4" URBAĪ Series****Classic IC and Air Tight New Construction Housing**

GOOF RINGS

For round trims.

Code: RR4-03SA (Satin Gold)
 RR4-04BR (Brushed Chrome)
 RR4-11 (Matte White)
 RR4-12BR (Brushed Nickel)
 RR4-13 (Satin Nickel)
 RR4-22 (Matte Black)

Outside diameter: \varnothing 6-1/8" (156 mm)
 Inside diameter: \varnothing 4-1/4" (108 mm)

For square trims.

Code: RS4-03SA (Satin Gold)
 RS4-04BR (Brushed Chrome)
 RS4-11 (Matte White)
 RS4-12BR (Brushed Nickel)
 RS4-13 (Satin Nickel)
 RS4-22 (Matte Black)

Outside dimensions: 5-1/2" (140 mm) x 5-1/2" (140 mm)
 Inside diameter: \varnothing 4-1/4" (108 mm)

CONTRASTE

1009, rue du Parc Industriel
 Lévis (Québec) G6Z 1C5 Canada
 Tel.: 1-888-839-4624
 Fax.: 1-877-839-7057
 contrastlighting.com
 info@contrastlighting.com

© 2017 Contrast Lighting M.L. Inc.
 All rights reserved

Contrast Lighting M.L. Inc. reserves the right to make changes in specifications and/or to discontinue any product at any time without notice or obligation and will not be liable for any consequences resulting from the use of this publication.